

X:\Clients\Hermiston\OR\736-134\_2nd St\CAD\736-134\_D-101.dwg, Layout1, 1/9/2024 8:42 AM, lwillhite

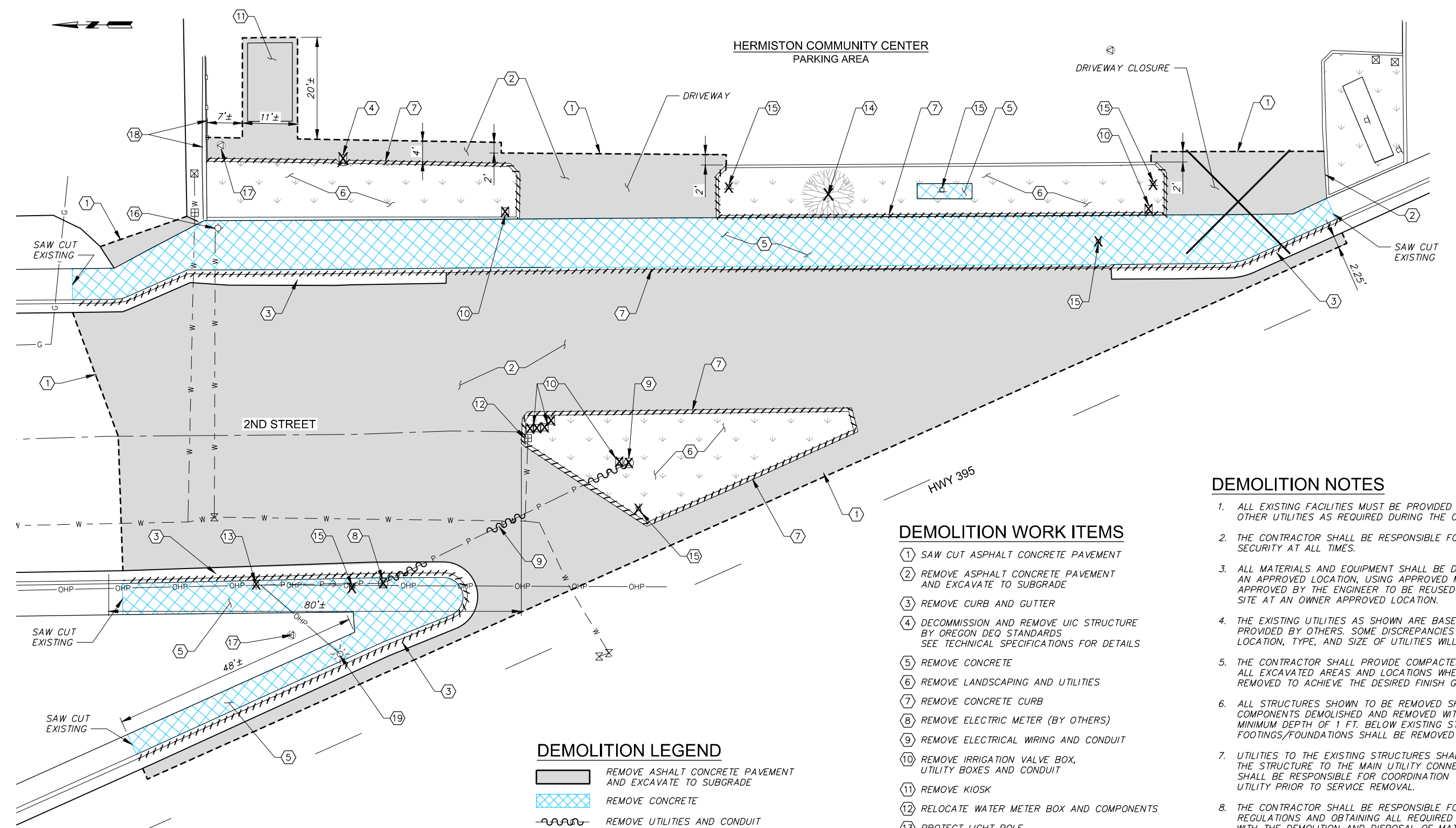

**DEMOLITION NOTES**

1. ALL EXISTING FACILITIES MUST BE PROVIDED WATER, SEWER, AND OTHER UTILITIES AS REQUIRED DURING THE COURSE OF THE WORK.
2. THE CONTRACTOR SHALL BE RESPONSIBLE FOR SITE SAFETY AND SECURITY AT ALL TIMES.
3. ALL MATERIALS AND EQUIPMENT SHALL BE DISPOSED OF OFF SITE AT AN APPROVED LOCATION, USING APPROVED METHODS. MATERIALS APPROVED BY THE ENGINEER TO BE REUSED MAY BE STOCKPILED ON SITE AT AN OWNER APPROVED LOCATION.
4. THE EXISTING UTILITIES AS SHOWN ARE BASED UPON INFORMATION PROVIDED BY OTHERS. SOME DISCREPANCIES AND OMISSIONS IN LOCATION, TYPE, AND SIZE OF UTILITIES WILL LIKELY OCCUR.
5. THE CONTRACTOR SHALL PROVIDE COMPACTED GENERAL BACKFILL IN ALL EXCAVATED AREAS AND LOCATIONS WHERE STRUCTURES ARE REMOVED TO ACHIEVE THE DESIRED FINISH GRADE.
6. ALL STRUCTURES SHOWN TO BE REMOVED SHALL HAVE ALL COMPONENTS DEMOLISHED AND REMOVED WITH EXCAVATION TO A MINIMUM DEPTH OF 1 FT. BELOW EXISTING STRUCTURE. ALL EXISTING FOOTINGS/FOUNDATIONS SHALL BE REMOVED WITH THE STRUCTURE.
7. UTILITIES TO THE EXISTING STRUCTURES SHALL BE REMOVED FROM THE STRUCTURE TO THE MAIN UTILITY CONNECTION. THE CONTRACTOR SHALL BE RESPONSIBLE FOR COORDINATION WITH THE APPROPRIATE UTILITY PRIOR TO SERVICE REMOVAL.
8. THE CONTRACTOR SHALL BE RESPONSIBLE FOR ADHERING TO ALL REGULATIONS AND OBTAINING ALL REQUIRED PERMITS ASSOCIATED WITH THE DEMOLITION AND DISPOSAL OF MATERIALS.
9. CONTRACTOR SHALL REMOVE ALL DEBRIS, REFUSE, AND OTHER MATERIAL ON THE SITE AT THE CONTRACTOR'S EXPENSE. MATERIALS TO BE SALVAGED SHALL BE IDENTIFIED AND REMOVED BY THE OWNER PRIOR TO THE BEGINNING OF THE PROJECT.
10. CONTRACTOR SHALL COORDINATE WITH THE CITY OF HERMISTON AND DEQ PRIOR TO REMOVAL OF DRYWELL. CONTRACTOR SHALL ADHERE TO ANY DEQ REQUIREMENTS FOR TESTING AND REPORTING.

**DEMOLITION WORK ITEMS**

- ① SAW CUT ASPHALT CONCRETE PAVEMENT
- ② REMOVE ASPHALT CONCRETE PAVEMENT AND EXCAVATE TO SUBGRADE
- ③ REMOVE CURB AND GUTTER
- ④ DECOMMISSION AND REMOVE UIC STRUCTURE BY OREGON DEQ STANDARDS SEE TECHNICAL SPECIFICATIONS FOR DETAILS
- ⑤ REMOVE CONCRETE
- ⑥ REMOVE LANDSCAPING AND UTILITIES
- ⑦ REMOVE CONCRETE CURB
- ⑧ REMOVE ELECTRIC METER (BY OTHERS)
- ⑨ REMOVE ELECTRICAL WIRING AND CONDUIT
- ⑩ REMOVE IRRIGATION VALVE BOX, UTILITY BOXES AND CONDUIT
- ⑪ REMOVE KIOSK
- ⑫ RELOCATE WATER METER BOX AND COMPONENTS
- ⑬ PROTECT LIGHT POLE
- ⑭ REMOVE TREE AND STUMP
- ⑮ REMOVE SIGN
- ⑯ PROTECT FIRE HYDRANT
- ⑰ PROTECT SURVEY CONTROL
- ⑱ PROTECT CURB AND CHAIN LINK FENCE
- ⑲ PROTECT LIGHT POLE

**DEMOLITION LEGEND**

- REMOVE ASPHALT CONCRETE PAVEMENT AND EXCAVATE TO SUBGRADE
- REMOVE CONCRETE
- REMOVE UTILITIES AND CONDUIT
- SAW CUT LINE
- REMOVE CURB
- REMOVE STRUCTURE
- REMOVE TREE

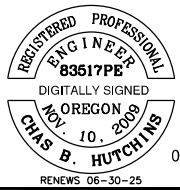
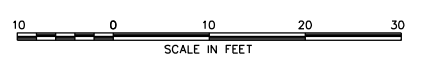

01/03/2024

DESIGNED BY	G. BANISTER	JOB NUMBER	736-134	DATE	2023
DRAWN BY	L. WILLHITE	ACAD FILE:	736-134_D-101.dwg		
REVIEWED BY	A. LINDSEY	COPYRIGHT 2023 BY ANDERSON PERRY & ASSOC., INC.			



**HERMISTON, OREGON**  
SE 2ND STREET AND HIGHWAY 395  
INTERSECTION IMPROVEMENTS - REBID

DEMOLITION PLAN

SHEET  
**D-101**  
3 OF 11

HERMISTON COMMUNITY CENTER  
PARKING AREA

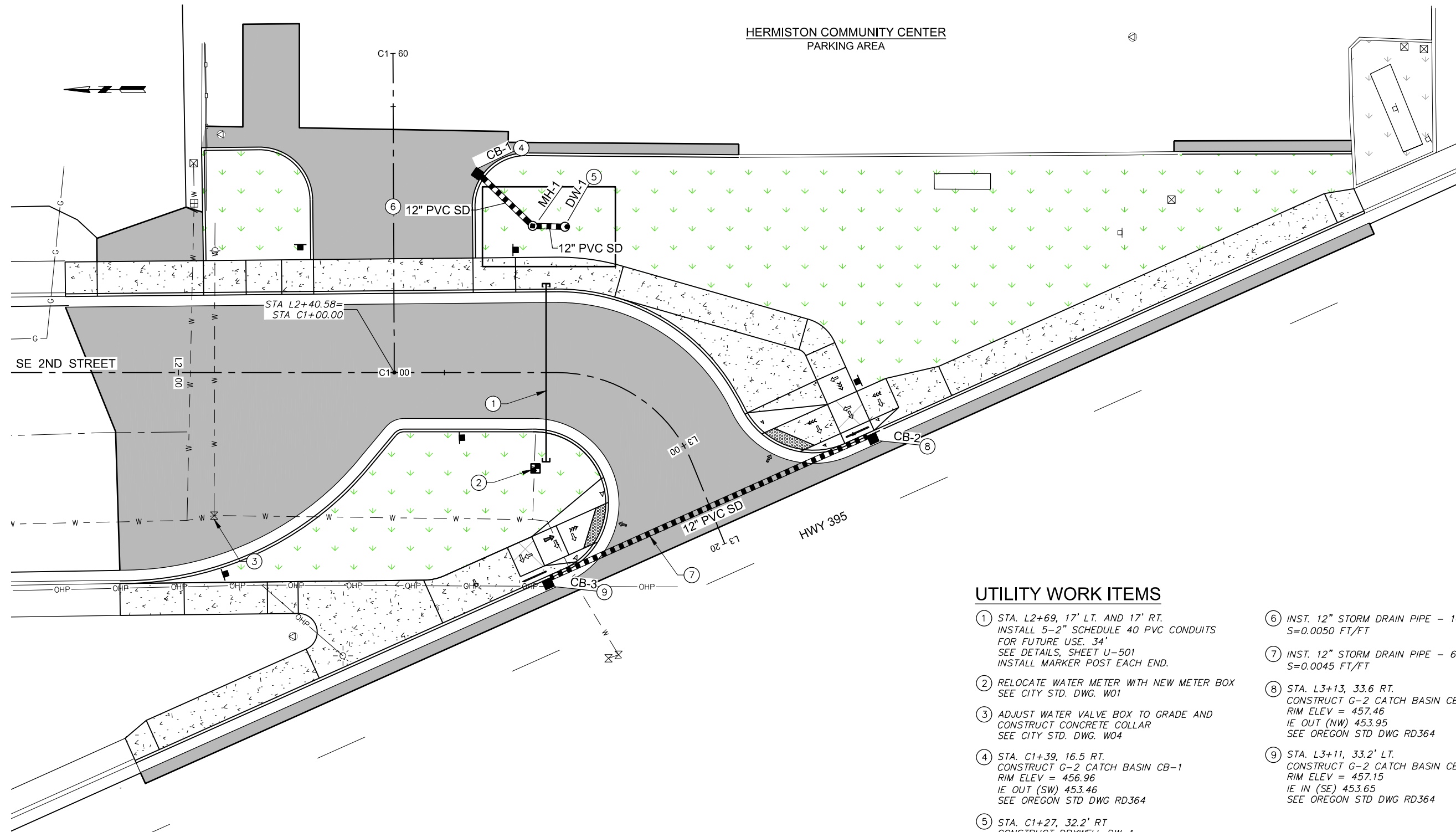

**UTILITY WORK ITEMS**

- ① STA. L2+69, 17' LT. AND 17' RT.  
INSTALL 5-2" SCHEDULE 40 PVC CONDUITS  
FOR FUTURE USE. 34'  
SEE DETAILS, SHEET U-501  
INSTALL MARKER POST EACH END.
- ② RELOCATE WATER METER WITH NEW METER BOX  
SEE CITY STD. DWG. W01
- ③ ADJUST WATER VALVE BOX TO GRADE AND  
CONSTRUCT CONCRETE COLLAR  
SEE CITY STD. DWG. W04
- ④ STA. C1+39, 16.5' RT.  
CONSTRUCT G-2 CATCH BASIN CB-1  
RIM ELEV = 456.96  
IE OUT (SW) 453.46  
SEE OREGON STD DWG RD364
- ⑤ STA. C1+27, 32.2' RT  
CONSTRUCT DRYWELL DW-1  
RIM ELEV = 457.42  
IE IN (NE) 453.40  
IE OUT 453.40  
SEE CITY STD. DWG. SD03
- ⑥ INST. 12" STORM DRAIN PIPE - 14'  
S=0.0050 FT/FT
- ⑦ INST. 12" STORM DRAIN PIPE - 67'  
S=0.0045 FT/FT
- ⑧ STA. L3+13, 33.6 RT.  
CONSTRUCT G-2 CATCH BASIN CB-2 W/ SUMP  
RIM ELEV = 457.46  
IE OUT (NW) 453.95  
SEE OREGON STD DWG RD364
- ⑨ STA. L3+11, 33.2' LT.  
CONSTRUCT G-2 CATCH BASIN CB-3 W/ SUMP  
RIM ELEV = 457.15  
IE IN (SE) 453.65  
SEE OREGON STD DWG RD364

X:\Clients\Hermiston\_OR\736-134\_2nd StCAD\736-134\_U-101.dwg, Layout1, 1/3/2024 8:45 AM, lwillhite

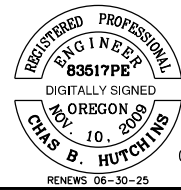

01/03/2024

DESIGNED BY	G. BANISTER	JOB NUMBER	736-134	DATE	2023
DRAWN BY	L. WILLHITE	ACAD FILE:	736-134_U-101.dwg		
REVIEWED BY	A. LINDSEY	COPYRIGHT 2023 BY ANDERSON PERRY & ASSOC., INC.			

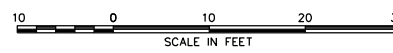

**HERMISTON, OREGON**  
SE 2ND STREET AND HIGHWAY 395  
INTERSECTION IMPROVEMENTS - REBID

UTILITY PLAN

SHEET  
**U-101**  
9 OF 11