

BUILDING/FACILITY KEY *

NO.	DESCRIPTION	TOP ELEV.	NO.	DESCRIPTION	TOP ELEV.	NO.	DESCRIPTION	TOP ELEV.
1	HANGAR (E)	667'	14	HANGAR (E)	664'	27	HANGAR (R)	-
2	HANGAR (E)	662'	15	HANGAR (E)	663'	28	T-HANGAR (R)	-
3	HANGAR (E)	665'	16	T-HANGAR (E)	656'	29	AG AREA (E)	-
4	HANGAR (E)	665'	17	OPEN T-HANGAR (E)	659'	30	SEGMENTED CIRCLE (E)	-
5	HANGAR (E)	665'	18	EQUIPMENT BUILDING (E)	652'	31	SEGMENTED CIRCLE (F)	-
6	FBO (E)	664'	19	AIRCRAFT FUEL APRON (E)	-	32	AIRCRAFT APRON (F)	-
7	FUEL (E)	653'	20	AIRCRAFT TIEDOWN APRON (E)	-	33	NON-AERONAUTICAL BUILDING (E)	-
8	FBO RESIDENCE (E)	660'	21	VEHICLE PARKING (PUBLIC) (E)	-	34	FBO APRON (F)	-
9	ELECTRICAL BUILDING (E)	654'	22	NON-AERO EQUIP. STORAGE (E)	-	35	AG AREA (F)	-
10	T-HANGAR (E)	658'	23	STORAGE BUILDING (E)	652'	36	T-HANGAR (E)	-
11	HANGAR (E)	661'	24	HANGAR (F)	-	37	NON-AERONAUTICAL BUILDING (E)	-
12	HANGAR (E)	665'	25	T-HANGAR (F)	-	38	NON-AERONAUTICAL BUILDING (E)	-
13	HANGAR (E)	663'	26	FBO HANGAR (F)	-			

* SEE TERMINAL AREA PLAN FOR DETAIL OF NORTH LANDSIDE FACILITIES.

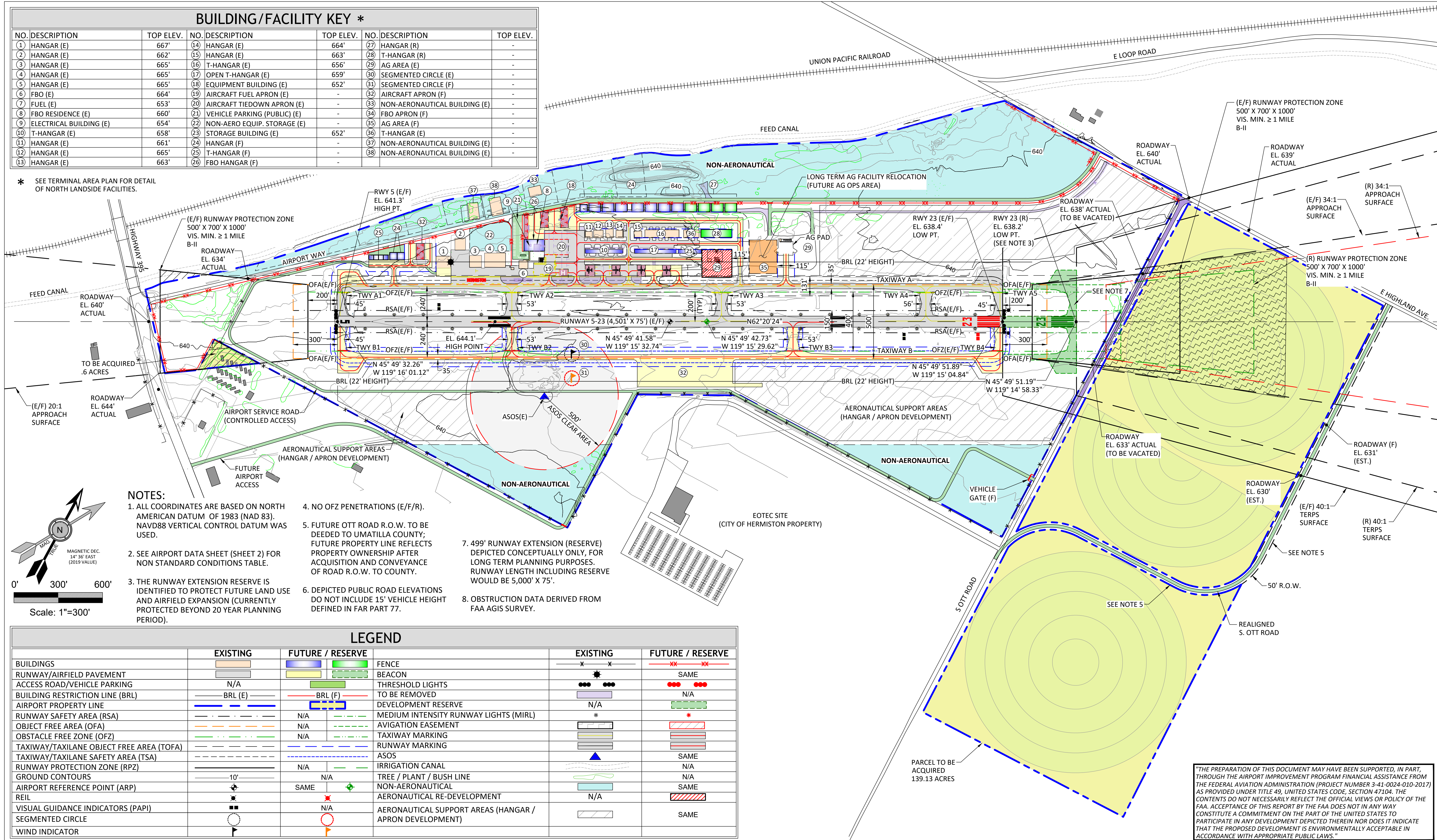

NOTES:

- ALL COORDINATES ARE BASED ON NORTH AMERICAN DATUM OF 1983 (NAD 83). NAVD88 VERTICAL CONTROL DATUM WAS USED.
- SEE AIRPORT DATA SHEET (SHEET 2) FOR NON STANDARD CONDITIONS TABLE.
- THE RUNWAY EXTENSION RESERVE IS IDENTIFIED TO PROTECT FUTURE LAND USE AND AIRFIELD EXPANSION (CURRENTLY PROTECTED BEYOND 20 YEAR PLANNING PERIOD).
- NO OFZ PENETRATIONS (E/F/R).
- FUTURE OTT ROAD R.O.W. TO BE DEEDED TO UMATILLA COUNTY; FUTURE PROPERTY LINE REFLECTS PROPERTY OWNERSHIP AFTER ACQUISITION AND CONVEYANCE OF ROAD R.O.W. TO COUNTY.
- DEPICTED PUBLIC ROAD ELEVATIONS DO NOT INCLUDE 15' VEHICLE HEIGHT DEFINED IN FAR PART 77.
- 499' RUNWAY EXTENSION (RESERVE) DEPICTED CONCEPTUALLY ONLY, FOR LONG TERM PLANNING PURPOSES. RUNWAY LENGTH INCLUDING RESERVE WOULD BE 5,000' X 75'.
- OBSTRUCTION DATA DERIVED FROM FAA AGIS SURVEY.

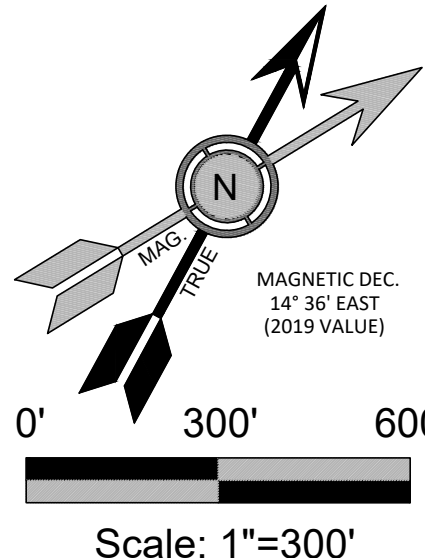

LEGEND

	EXISTING	FUTURE / RESERVE		EXISTING	FUTURE / RESERVE
BUILDINGS	[Orange Box]	[Green Box]	FENCE	[Black X]	[Red X]
RUNWAY/AIRFIELD PAVEMENT	[Grey Box]	[Light Green Box]	BEACON	[Black Star]	[Red Star]
ACCESS ROAD/VEHICLE PARKING	[Light Grey Box]	[Light Green Box]	THRESHOLD LIGHTS	[Black Dots]	[Red Dots]
BUILDING RESTRICTION LINE (BRL)	[Blue Line]	[Red Line]	TO BE REMOVED	[Purple Box]	[N/A]
AIRPORT PROPERTY LINE	[Blue Line]	[Blue Line]	DEVELOPMENT RESERVE	[N/A]	[Green Box]
RUNWAY SAFETY AREA (RSA)	[Blue Line]	[Blue Line]	MEDIUM INTENSITY RUNWAY LIGHTS (MIRL)	[Black Star]	[Red Star]
OBJECT FREE AREA (OFA)	[Orange Line]	[Orange Line]	AVIGATION EASEMENT	[Grey Box]	[Red Box]
OBSTACLE FREE ZONE (OFZ)	[Green Line]	[Green Line]	TAXIWAY MARKING	[Grey Box]	[Red Box]
TAXIWAY/TAXILANE OBJECT FREE AREA (TOFA)	[Blue Line]	[Blue Line]	RUNWAY MARKING	[Grey Box]	[Red Box]
TAXIWAY/TAXILANE SAFETY AREA (TSA)	[Blue Line]	[Blue Line]	ASOS	[Blue Triangle]	[Red Triangle]
RUNWAY PROTECTION ZONE (RPZ)	[Blue Line]	[Blue Line]	IRRIGATION CANAL	[Blue Line]	[N/A]
GROUND CONTOURS	[Grey Line]	[N/A]	TREE / PLANT / BUSH LINE	[Green Line]	[N/A]
AIRPORT REFERENCE POINT (ARP)	[Black X]	[Green X]	NON-AERONAUTICAL	[Blue Box]	[Red Box]
REIL	[Black X]	[Red X]	AERONAUTICAL RE-DEVELOPMENT	[N/A]	[Red Box]
VISUAL GUIDANCE INDICATORS (PAPI)	[Black X]	[N/A]	AERONAUTICAL SUPPORT AREAS (HANGAR / APRON DEVELOPMENT)	[Blue Box]	[Red Box]
SEGMENTED CIRCLE	[Black Circle]	[Red Circle]			
WIND INDICATOR	[Black Arrow]	[Red Arrow]			

"THE PREPARATION OF THIS DOCUMENT MAY HAVE BEEN SUPPORTED, IN PART, THROUGH THE AIRPORT IMPROVEMENT PROGRAM FINANCIAL ASSISTANCE FROM THE FEDERAL AVIATION ADMINISTRATION (PROJECT NUMBER 3-41-0024-010-2017) AS PROVIDED UNDER TITLE 49, UNITED STATES CODE, SECTION 47104. THE CONTENTS DO NOT NECESSARILY REFLECT THE OFFICIAL VIEWS OR POLICY OF THE FAA. ACCEPTANCE OF THIS REPORT BY THE FAA DOES NOT IN ANY WAY CONSTITUTE A COMMITMENT ON THE PART OF THE UNITED STATES TO PARTICIPATE IN ANY DEVELOPMENT DEPICTED THEREIN NOR DOES IT INDICATE THAT THE PROPOSED DEVELOPMENT IS ENVIRONMENTALLY ACCEPTABLE IN ACCORDANCE WITH APPROPRIATE PUBLIC LAWS."

NO.	DATE	BY	APPR	REVISIONS	<p>VERIFY SCALES BAR IS ONE INCH ON ORIGINAL DRAWING. 0" IF NOT ONE INCH ON THIS SHEET, ADJUST SCALES ACCORDINGLY.</p>	<p>FEDERAL AVIATION ADMINISTRATION APPROVAL</p> <p>APPROVAL DATE: _____</p> <p>SIGNATURE _____</p>	<p>CITY OF HERMISTON APPROVAL</p> <p>APPROVAL DATE: _____</p> <p>SIGNATURE _____</p>	<p>CENTURY WEST ENGINEERING</p> <p>BEND OFFICE 1020 SW EMIKAY DRIVE., #100 BEND, OR 97702 541.322.8962 OFFICE 541.382.2423 FAX</p>	<p>HERMISTON MUNICIPAL AIRPORT</p> <p>AIRPORT LAYOUT PLAN</p>	<p>FIGURE NO. -</p> <p>SHEET NO. 3 OF 12</p>
DESIGNED BY: DM	DRAWN BY: JLS	CHECKED BY: -	SCALE: AS SHOWN	DATE: JANUARY 2020		PROJECT NO: 10300.001.01				